



KONICA MINOLTA

bizhub 654e

Black & white A3 multifunctional

Up to 65 pages per minute

Functionality



Copying

- Black & white



Printing

- Black & white
- PCL/PS
- Local/Network
- USB



Scanning

- Colour
- Black & white
- Scan-to-eMail
- Scan-to-Me
- Scan-to-SMB
- Scan-to-Home
- Scan-to-FTP
- Scan-to-Box
- Scan-to-USB
- Scan-to-WebDAV
- Scan-to-DPWS
- TWAIN Network



Faxing

- Super G3 Fax
- PC-Fax
- i-Fax
- IP-Fax



Box

- Reprint
- Distribution
- Sharing
- Box-to-Box
- Box-to-USB



Giving Shape to Ideas

Technology

Emperon™ – print controller	Simply compatible to users and IT environments thanks to Konica Minolta unified print technology	✓
Simitri® HD – polymerised toner	Pays off to budget and green footprint by high quality and low environmental impact	✓
OpenAPI – solution platform	Enable efficient workflows throughout your MFP fleet by server-based applications	✓
i-Option – special features	Increase the scope of MFP functionality from basic to advance depending on your needs	✓
CSRC – remote service	Keep productivity up by online device and consumable monitoring of the Konica Minolta service	✓
Panel customisation ready	Improved user-device interaction and productivity by full MFP panel customisation to your needs	✓

Option diagram

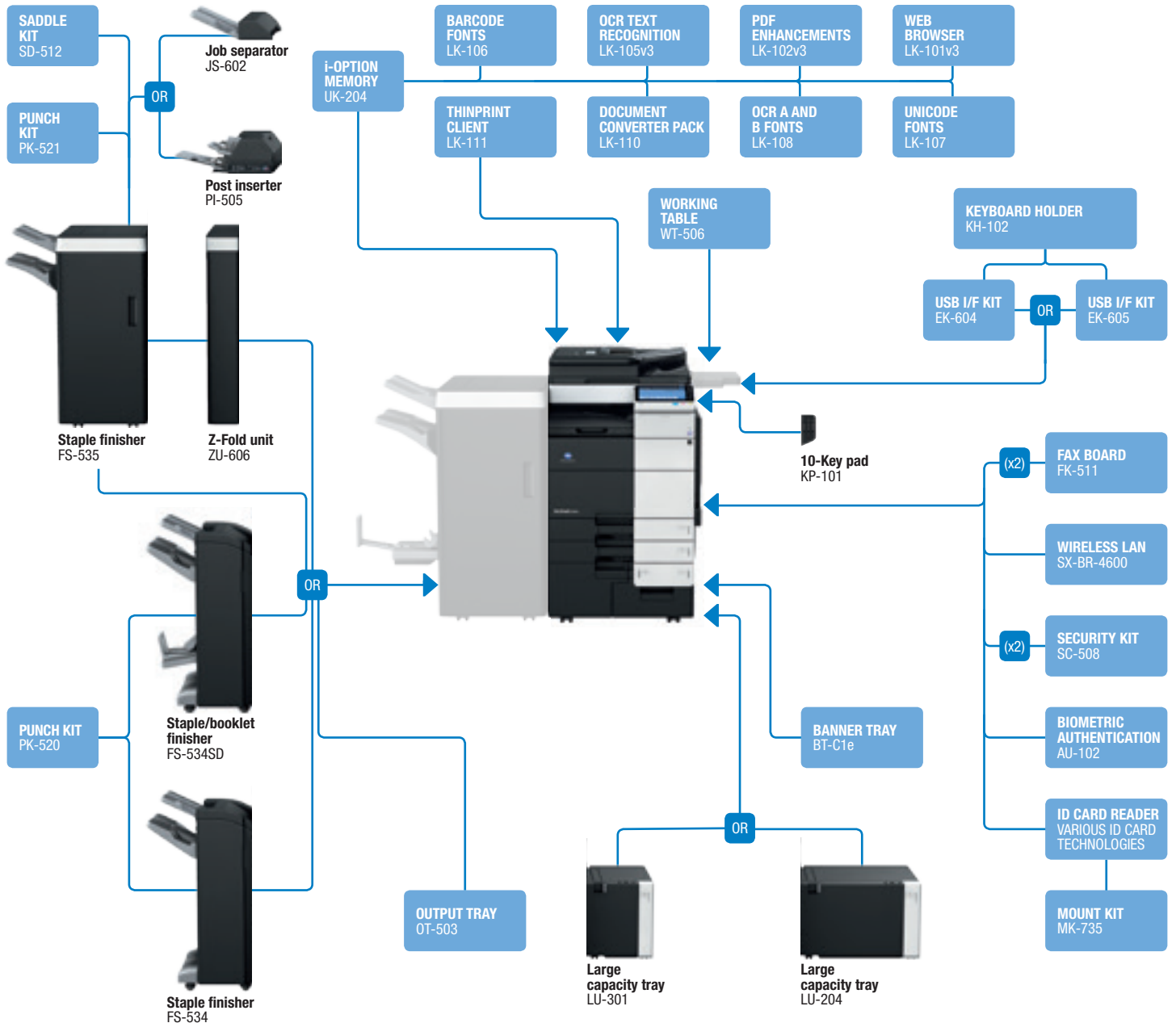

Finishing options

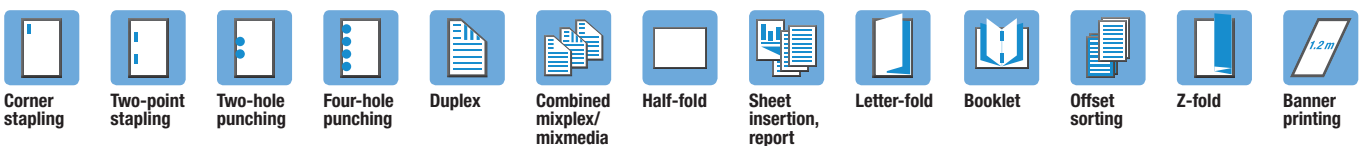

Descriptions

bizhub 654e	Communication centre with 65 ppm b/w. Standard Emperon™ print controller with PCL 6, PCL 5, PostScript 3, PDF 1.7 XPS and OOXML support. Paper capacity of 3500 and 150-sheet manual bypass. Media from A6 to SRA3, 1.2 m banner and 52–300 gsm. 2 GB memory, 250 GB hard disk and Gigabit Ethernet standard.
LU-204 Large capacity tray	A4–SRA3, 2,500 sheets, 52–256 gsm
LU-301 Large capacity tray	A4, 3,000 sheets, 52–256 gsm
FS-535 Staple finisher	100 sheets stapling, 3,200 sheets max. output
PK-521 Punch kit	2/4 hole punching, autoswitching
SD-512 Saddle kit	Booklet finishing, half-fold, letter-fold
PI-505 Post inserter	Cover insertion, post finishing
JS-602 Job separator	Job separator e.g. for fax output
ZU-606 Z-fold unit	Z-fold for A3 prints, 2/4 hole punching
FS-534 Staple finisher	50-sheet stapling, 3,200 sheets max. output
FS-534SD Booklet finisher	50-sheets staple finisher, 20-sheets booklet finisher, 2,200 sheets max. output
PK-520 Punch kit for FS-534/SD	2/4 hole punching, autoswitching
OT-503 Output tray	Output tray used instead of finisher
KP-101 10-Key pad	For use instead of touchscreen

WT-506 Working table	Authentication device placement
BT-C1e Banner tray	Multi-page banner
FK-511 Fax board	Super G3 fax, digital fax functionality
KH-102 Keyboard holder	To place USB keyboard
EK-604 USB I/F kit	USB keyboard connection
EK-605 USB I/F kit	USB keyboard connection, Bluetooth
ID card reader	Various ID card technologies
MK-735 Mount kit	Installation kit for ID card reader
AU-102 Biometric authentication	Finger vein scanner
SC-508 Security kit	Copy guard function
LK-101 Web browser	Web browser and image panel
LK-102 PDF enhancements	PDF/A, PDF encryption, digital signature
LK-105 OCR text recognition	Searchable PDF and PPTX
LK-106 Barcode fonts	Supports native barcode printing
LK-107 Unicode fonts	Supports native Unicode printing
LK-108 OCR A and B fonts	Supports native OCR A and B font printing
LK-110 Document converter pack	Generates various file formats incl. DOCX and XLSX
LK-111 ThinPrint® Client	Print data compression for reduced network impact
UK-204 i-Option memory	Memory extension for i-Options
SX-BR-4600 Wireless LAN	Wireless LAN to network connector

Technical specifications

SYSTEM SPECIFICATIONS

System memory	2,048 MB (standard)
System hard disk	250 GB (standard)
Interface	10-Base-T/100-Base-T/1,000-Base-T Ethernet; USB 2.0
Network protocols	TCP/IP (IPv4 / IPv6); IPX/SPX; NetBEUI; AppleTalk (EtherTalk); SMB; LPD; IPP; SNMP; HTTP
Frame types	Ethernet 802.2; Ethernet 802.3; Ethernet II; Ethernet SNAP
Automatic document feeder	Up to 150 originals; A6–A3; 35–210 gsm
Printable paper size	Dualscan ADF A6–SRA3, customised paper sizes; banner paper max. 1,200 x 297 mm
Printable paper weight	52–300 gsm
Paper input capacity	Standard: 3,650 sheets Max.: 6,650 sheets
Tray 1	500 sheets, A5–SRA3, 52–256 gsm
Tray 2	500 sheets, A5–SRA3, 52–256 gsm
Tray 3	1,500 sheets, A4, 52–256 gsm
Tray 4	1,000 sheets, A4, 52–256 gsm
Manual bypass	150 sheets, A6–SRA3, custom sizes, banner, 52–300 gsm
Large capacity cabinet 1 (optional)	3,000 sheets, A4, 52–256 gsm
Large capacity cabinet 2 (optional)	2,500 sheets, A4–SRA3, 52–256 gsm
Automatic duplexing	A5–SRA3; 52–256 gsm
Finishing modes (optional)	Offset; group; sort; staple; punch; post insertion; z-fold; centre-fold; letter fold; booklet
Output capacity (with finisher)	Max.: 3,300 sheets
Output capacity (without finisher)	Max.: 250 sheets
Stapling	Max.: 100 sheets or 98 sheets + 2 cover sheets (up to 209 gsm)
Stapling output capacity	Max.: 1,000 sheets
Letter fold	Up to 3 sheets
Letter fold capacity	Max.: 30 sheets (tray); unlimited
Booklet	Max.: 20 sheets or 19 sheets + 1 cover sheet (up to 209 gsm)
Booklet output capacity	Max.: 100 sheets (tray); unlimited
Copy/print volume (monthly)	Rec.: 80,000 pages; Max.: 187,000 pages
Toner lifetime	48,960 pages
Imaging unit lifetime	300,000 pages/1,200,000 pages (Drum/Developer)
Power consumption	220–240 V / 50/60 Hz Less than 2.1 kW (system)
System dimensions (W x D x H)	650 x 799 x 1,155 mm
System weight	Approx. 201 kg

COPIER SPECIFICATIONS

Copying process	Electrostatic laser copy, tandem, indirect
Toner system	Simitri® HD polymerised toner
Copy/print speed A4	Up to 65 ppm
Copy/print speed A3	Up to 33 ppm
Autoduplex speed A4	Up to 65 ppm
1st copy out time	3.7 sec.
Warm-up time	Approx. 22 sec. ¹
Copy resolution	600 x 600 dpi
Gradation	256 gradations
Multicopy	1–9,999
Original format	A5–A3
Magnification	25–400% in 0.1% steps; auto-zooming
Copy functions	Chapter; cover and page insertion; proof copy (print and screen); adjustment test print; digital art functions; job setting memory; poster mode; image repeat; overlay (optional); stamping; copy protection

PRINTER SPECIFICATIONS

Print resolution	1,800 x 600 dpi; 1,200 x 1,200 dpi
Page description language	PCL6 (XL 3.0); PCL 5; PostScript 3 (CPSI 3016); XPS
Operating systems	Windows XP (32/64) Windows VISTA (32/64) Windows 7 (32/64) Windows 8 (32/64) Windows Server 2000 Windows Server 2003 (32/64) Windows Server 2008 (32/64) Windows Server 2008 R2 (64) Windows Server 2012 (64) Macintosh OS X 10.x Unix, Linux, Citrix
Printer fonts	80 PCL Latin; 137 PostScript 3 Emulation Latin
Print functions	Direct print of PCL, PS, TIFF, XPS, PDF, encrypted PDF files and OOXML (DOCX, XLSX, PPTX); mixmedia and mixplex; “Easy Set” job programming; overlay; watermark; copy protection; carbon copy print

¹ Warm-up time may vary depending on the operating environment and usage

SCANNER SPECIFICATIONS

Scan speed (mono/colour)	Up to 180 ipm
Scan resolution	Max.: 600 x 600 dpi
Scan modes	Scan-to-eMail (Scan-to-Me) Scan-to-SMB (Scan-to-Home) Scan-to-FTP Scan-to-Box Scan-to-USB Scan-to-WebDAV Scan-to-DPWS Network TWAIN scan
File formats	JPEG; TIFF; PDF; PDF/A 1a and 1b (optional); Compact PDF; encrypted PDF; searchable PDF (optional); XPS; compact XPS; PPTX and searchable PPTX (optional); searchable DOCX/ XLSX (optional)
Scan destinations	2,100 (single + group); LDAP support
Scan functions	Annotation (text/time/date) for PDF; up to 400 job programs; realtime scan preview

FAX SPECIFICATIONS

Fax standard	Super G3 (optional)
Fax transmission	Analogue i-Fax Colour i-Fax (RFC3949-C) IP-Fax
Fax resolution	Max.: 600 x 600 dpi (ultra-fine)
Fax compression	MH; MR; MMR; JBIG
Fax modem	Up to 33.6 Kbps
Fax destinations	2,100 (single + group)
Fax functions	Polling; time shift; PC-Fax; receipt to confidential box; Receipt to e-mail/FTP/SMB; up to 400 job programs

USER BOX SPECIFICATION

Max. storable documents	Up to 3,000 documents or 10,000 pages
Type of user boxes	Public Personal (with password or authentication) Group (with authentication)
Type of system boxes	Secure print Encrypted PDF print Fax receipt Fax polling
User box functionality	Reprint; combination Download Sending (e-mail/FTP/SMB and fax) Copy box to box

SYSTEM FEATURES

Security	ISO 15408 EAL3 (in evaluation); IP filtering and port blocking; SSL2; SSL3 and TLS1.0 network communication; IPsec support; IEEE 802.1x support; user authentication; Authentication log; secure print; Hard disk overwrite (8 standard types); Hard disk data encryption (AES 128); Memory data auto deletion; Confidential fax receipt; Print user data encryption; copy protection (Copy Guard, Password Copy) optional
Accounting	Up to 1,000 user accounts; Active Directory support (user name + password + e-mail + smb folder) User function access definition Biometric authentication (finger vein scanner) optional ID card authentication (ID card reader) optional"
Software	PageScope Net Care Device Manager PageScope Data Administrator PageScope Box Operator PageScope Direct Print Print Status Notifier Driver Packaging Utility Log Management Utility

- All specifications refer to A4-size paper of 80 gsm quality.
- The support and availability of the listed specifications and functionalities varies depending on operating systems, applications and network protocols as well as network and system configurations.
- The stated life expectancy of each consumable is based on specific operating conditions such as page coverage for a particular page size (5% coverage of A4). The actual life of each consumable will vary depending on use and other printing variables including page coverage, page size, media type, continuous or intermittent printing, ambient temperature and humidity.
- Some of the product illustrations contain optional accessories.
- Specifications and accessories are based on the information available at the time of printing and are subject to change without notice.
- Konica Minolta does not warrant that any specifications mentioned will be error-free.
- All brand and product names may be registered trademarks or trademarks of their respective holders and are hereby acknowledged.

